

Allow minimum of 5 1/2" clearance from the grill's rear edge (6 1/4" from cutout) to the backsplash to allow the hood to fully open.

Rotisserie Motor can be installed either on the right hand side or left hand side.

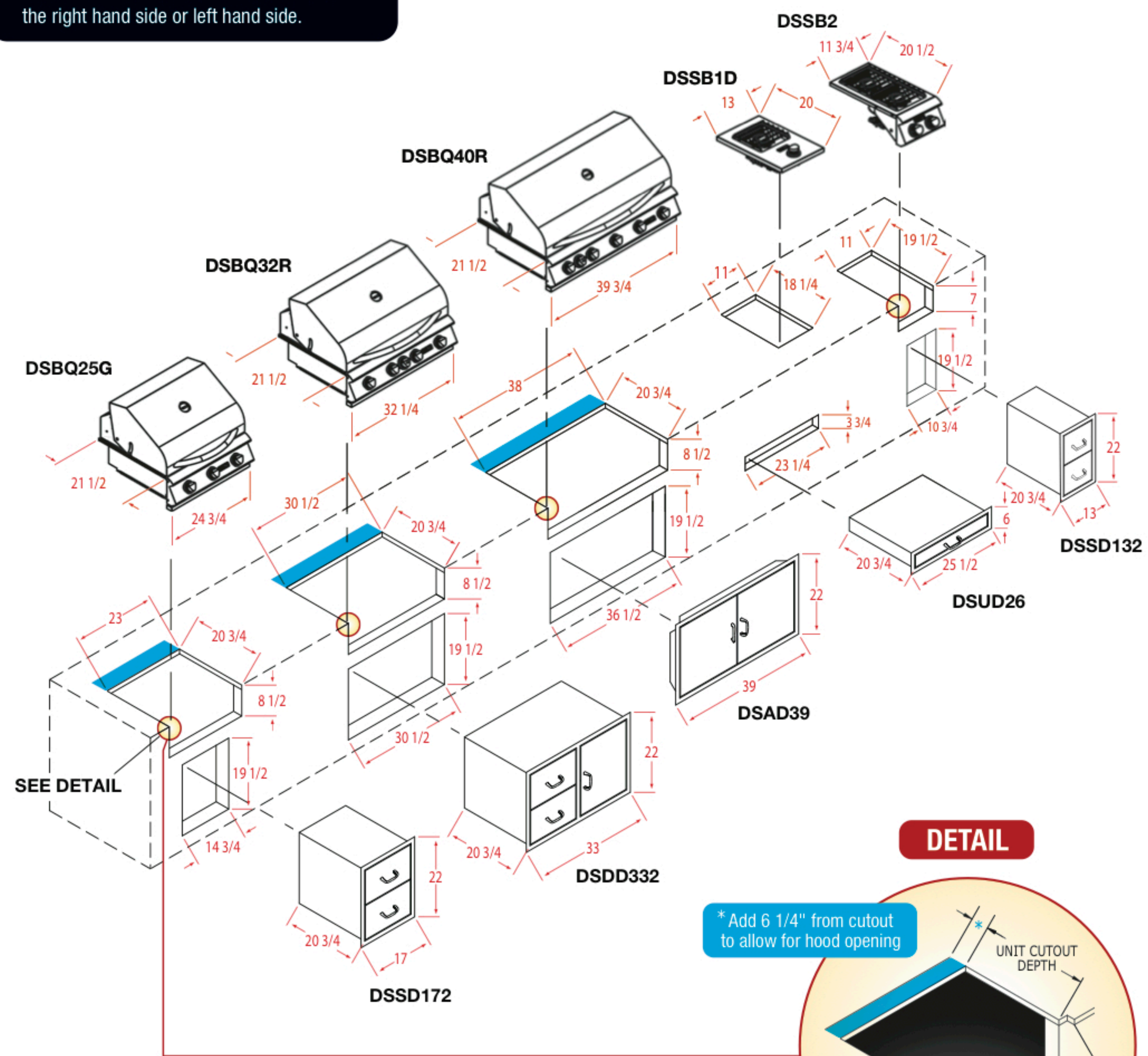

Note: Required to ensure a flush fit of all grills and the double side burner.

INSULATING JACKETS
For installation in combustible construction

MODEL	A	B
DSIJ25	29 3/8	27 1/2
DSIJ32	36 7/8	35
DSIJ40	44 3/8	42 1/2

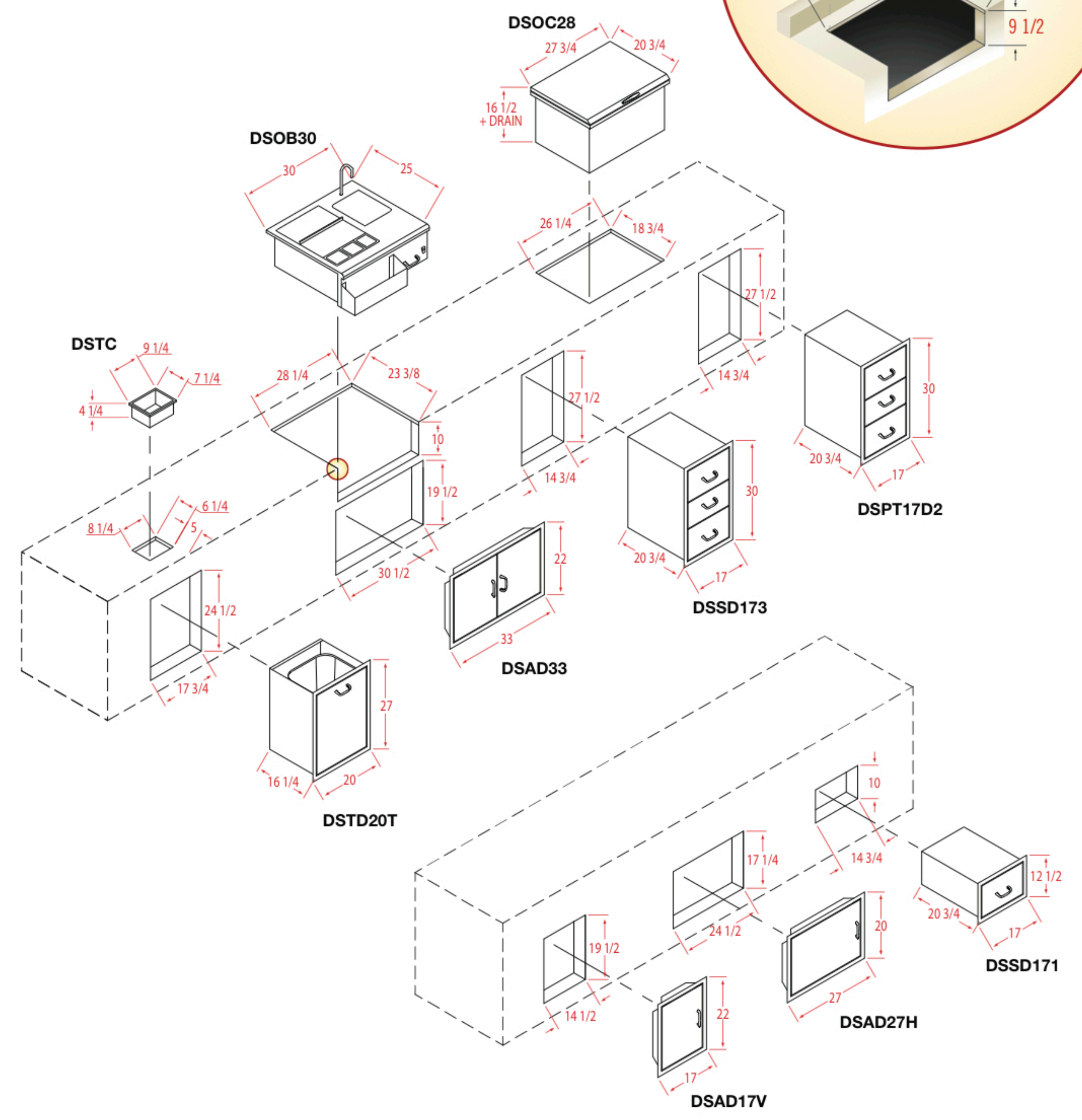
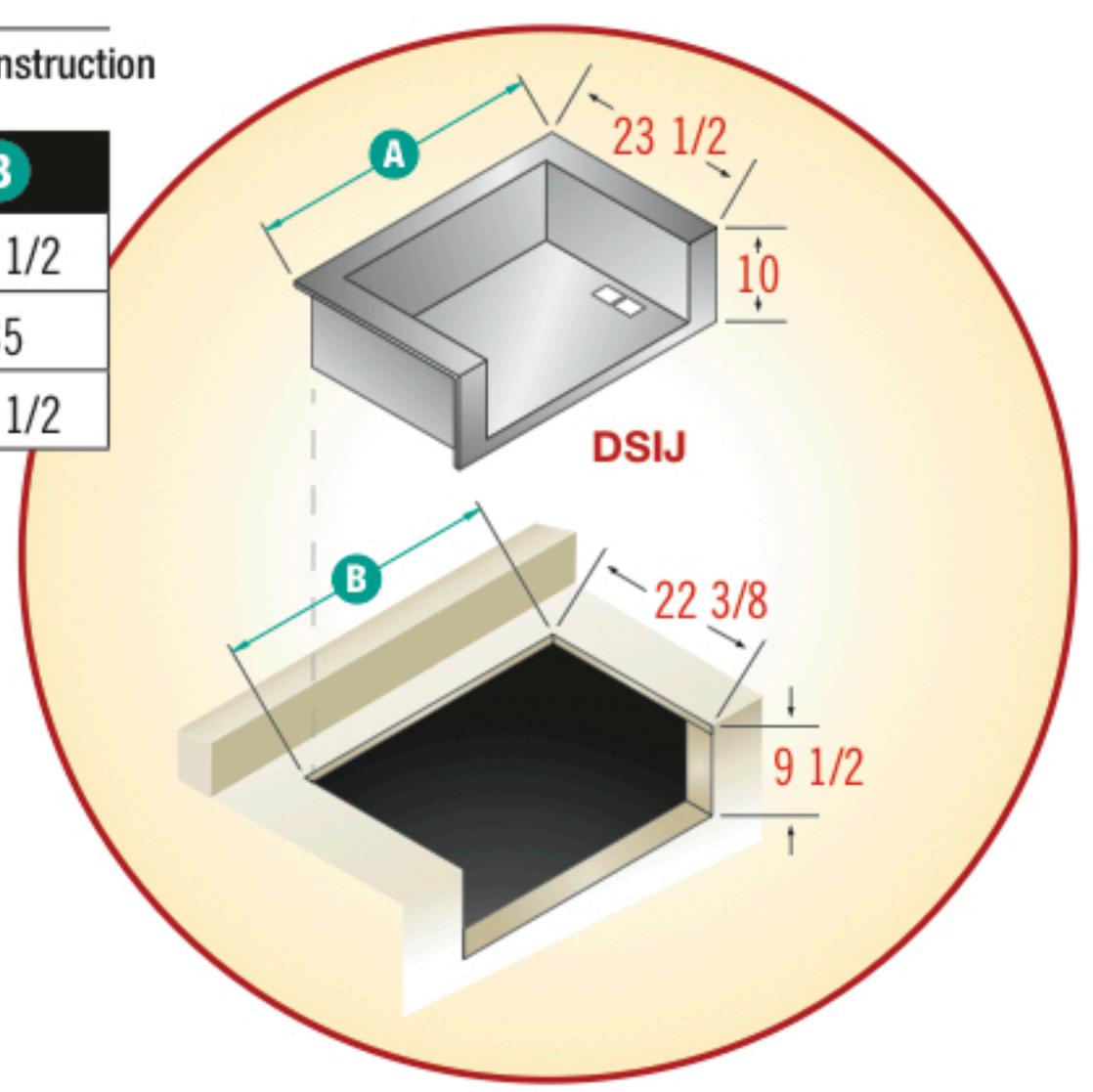

(Effective: November 2015)
For the constant advancement of our products, Delsol reserves the right to change the specifications, designs, and materials of the products without prior notification.